

Deco Safe 5250

Formerly marketed as **Tucana 5250**

*The perfect choice for
beauty and safety*

**25 Gauge (.019" min)
2" Sections**

Shown with custom painted Sanford design and 6 pane windows

Beauty, Durability, Safety

The Hörmann Deco Safe 5250 offers the beauty of recessed panel design and unsurpassed safety of our FingerGuard™ pinch-resistant joints. The virtually maintenance-free Deco Safe doors feature a tough steel front and back with polystyrene core, giving an R value of 6.9. A wide range of standard designs is available to complement your home.

Deep tongue and groove section joint contribute to the door's **excellent strength**. Intermediate seals prevent air infiltration, which enhances the **insulation** properties.

The steel front and back 3-layer sandwich construction with **insulating polystyrene core** increases energy savings and provides a very smooth and quiet door operation.

Recessed panel inlay designs with easy to clean woodgrain texture, galvanized and **finish painted steel** provide years of trouble-free performance and beauty.

The bottom weather seal **keeps out wind, rain, debris and other elements** for added energy savings.

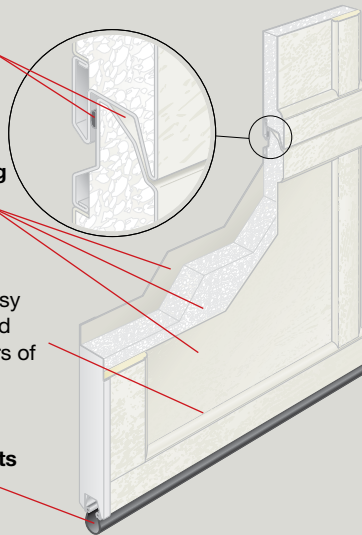

Choose your own design

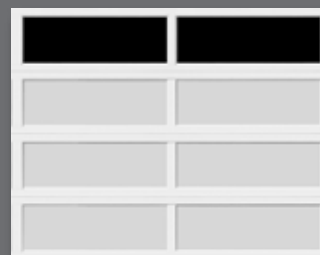

Longwood
with Standard windows

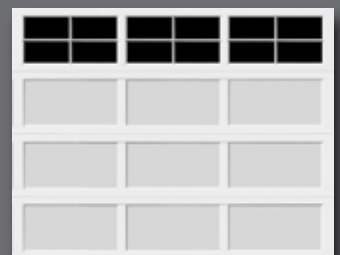

Sorrento
with 4 pane windows



Sanford
with 2 pane windows



Davenport
with 4 & 6 pane windows

Hörmann Innovations

FingerGuard™ Pinch Resistant



The FingerGuard™ section joint and hinges provide airtight seal and prevent finger injuries inside and outside.

White 11 Ball Bearing Nylon Rollers

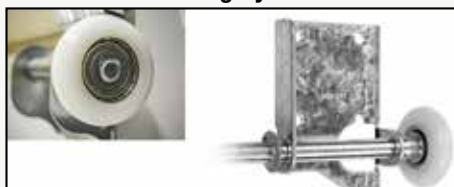

Hörmann nylon rollers feature 11 pre-lubed ball bearings encased in a high strength steel casing that provides a quiet ride and years of reliable service.

Between Section & Side Seals



Factory installed between section weather seal and side seal offer maximum protection from the outside elements while further enhancing the insulation properties of a door.

Choose the color which best suits your home

White

Sandstone

Galaxy Paint System

Hörmann's exclusive Galaxy Paint System is available to further customize your new Deco Safe door with 28 semi-custom colors or unlimited color matching capabilities.



With Hörmann Galaxy Paint System, you will not only be confident that you have purchased the highest quality and safest garage door for your home but one that will match the color of its exterior with a factory finish that will last.

Specifications

Series	Deco Safe 5250
Steel Thickness	25 ga.
Section Thickness	2 in.
R - Value	6.9
Polystyrene Core Insulation	Standard
Panel Designs	
Longwood	Standard
Sorrento	Standard
Sanford	Standard
Davenport	Standard
Available Colors	
White	Standard
Sandstone	Standard
Warranty	
Sections	Limited Lifetime
Hardware	6 years
Springs	3 years



Ask your dealer for details

SilentDrive®

The advanced technology in SilentDrive® garage door openers provide:

- Ultra quiet performance
- Unique safety features
- Maximum convenience



Select your favorite window design

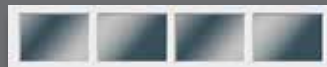

Glazed standard short

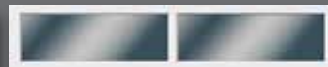

Glazed standard long

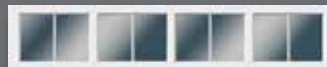

Glazed 2 pane

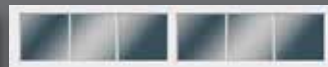

Glazed 3 pane

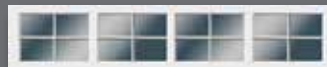

Glazed 4 pane



Glazed 6 pane

Made To Order Designs

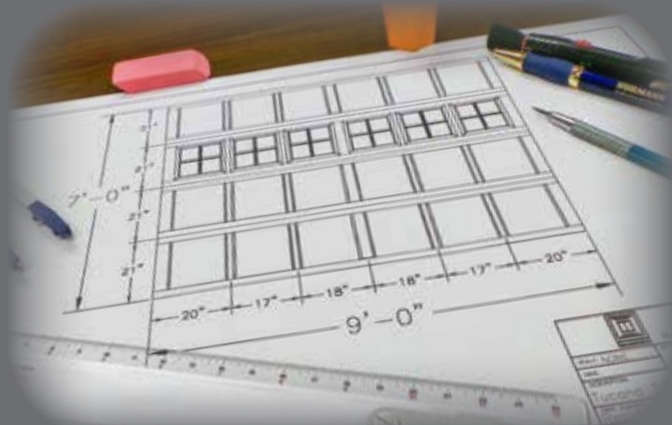

Whether you are matching an existing recessed panel door or have a custom panel arrangement in mind, Hörmann can deliver the perfect look that you are looking for. Simply provide your Hörmann Authorized Dealer with the panel dimensions for your custom door and we will provide an engineering drawing for your approval.

AVAILABLE FROM:



Eastern & Central Time Zones
Hörmann Group North America, Inc.
450 Airport Road, Sparta, TN 38583
Email: info1@hormann.us
website: www.hormann.us



Mountain & Western Time Zones
Hörmann Northwest Door, LLC
19000 Canyon Road East, Puyallup, WA 98375
Email: info@northwestdoor.com
website: www.northwestdoor.com

Everything you've always wanted in a garage door, and more.

HÖRMANN